

Preliminary Class J Fused Switch

DISCONNECT SWITCHES



Mersen's Class J Fused Switch incorporates switch functionality with the high protection level of a fuse. The switch accepts UL Class J fuses up to 60A. In addition to this, the Class J Fused Switch is UL 98 listed and suitable for use as main/feeder device and, in conjunction with Class J fuses, is rated for branch circuit protection. It has a smaller footprint compared to a traditional Class J disconnect with a max interrupting rating of 200kA.

The compact form factor and ease of installation makes it a great choice for panel builders. The easy lockout/tagout feature and IP20 rating ensures additional safety along with the built in switch capability.

Technical Data Overview	
FS30JX	
Volts	1 pole: 347AC/125 DC 2 and 3 pole: 600VAC (700VAC self certified)
Amps	30A
Short Circuit Current Rating (SCCR)	200 kA AC/100 kA DC
Wire Type	75°C CU Wire or Higher (CU75)
Fuse Class	J
FS60JX	
Volts	1 pole: 347AC/125 DC 2 and 3 pole: 600VAC (700VAC self certified)
Amps	60A
Short Circuit Current Rating (SCCR)	200 kA AC/100 kA DC
Wire Type	75°C CU Wire or Higher (CU75)
Fuse Class	J

FEATURES/BENEFITS

- UL 98 30A and 60A Fused Switch
- Smaller footprint compared to a traditional Class J disconnect
- Accepts Class J 30A and 60A fuses for branch circuit protection
- 35mm DIN rail mounted
- Built-in lockout/tagout feature
- 200kA SCCR rating
- 75°C CU Wire
- Minimum Indicator Voltage - 90V-AC and 12V-DC

APPLICATIONS

- Industrial control panels
- Data centers
- Main disconnects
- Motor branch circuit protection
- Fused Coordination Panels
- For use as a motor disconnect, see horsepower rating section below

APPROVALS/STANDARDS

- cULus Listed file No. WHTY. E191605
 - UL 98 - Open type switches
- IEC 60529 degree of protection IP20
- IEC 60947-7-3



TERMINAL SPECIFICATIONS

- Wire range #2-14 AWG
- Solid copper wire range 10-14 AWG
- Wire strip length 5/8"
- Terminal screw driver: Philips – slot
- Dual wire rated for same-size wire. See table below.

FACTORY & FIELD WIRING

- Minimum Indicator Voltage - 90VAC

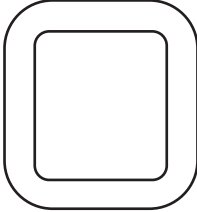
Line Side/Load Side	Wire Size (CU Stranded)	Torque	Wires Materials	Wire Type
	#2-14 AWG (2) #6-14 AWG	40 lbf. In 4.5 N.m	CU	Stranded
	#10-14 AWG (2) #10-14 AWG	25 lbf. in 2.8 N.m	CU	Solid

HORSE POWER RATINGS – FOR MOTOR DISCONNECT APPLICATIONS

Catalog Number	Type	120VAC		240VAC		480VAC		600VAC	
		1 Phase	3 Phase	1 Phase	3 Phase	1 Phase	3 Phase	1 Phase	3 Phase
FS30J1	1 pole 30A	1.5							
FS30J2	2 pole 30A			3					
FS30J3	3 pole 30A				5		10		15
FS60J1	1 pole 60A	3	-	-	-	-	-	-	-
FS60J2	2 pole 60A	-	-	7.5	-	-	-	-	-
FS60J3	3 pole 60A	-	-	-	7.5	-	20	-	15

PRODUCT DIMENSIONS

FS30JX

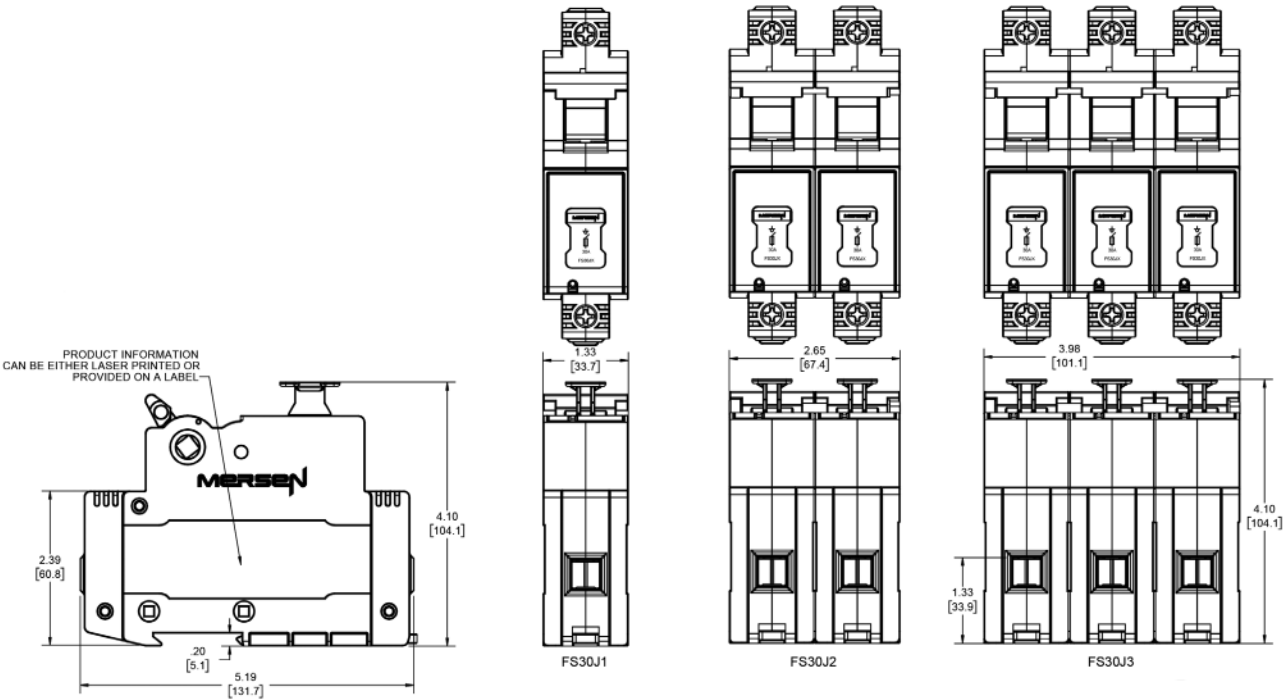

FS60JX

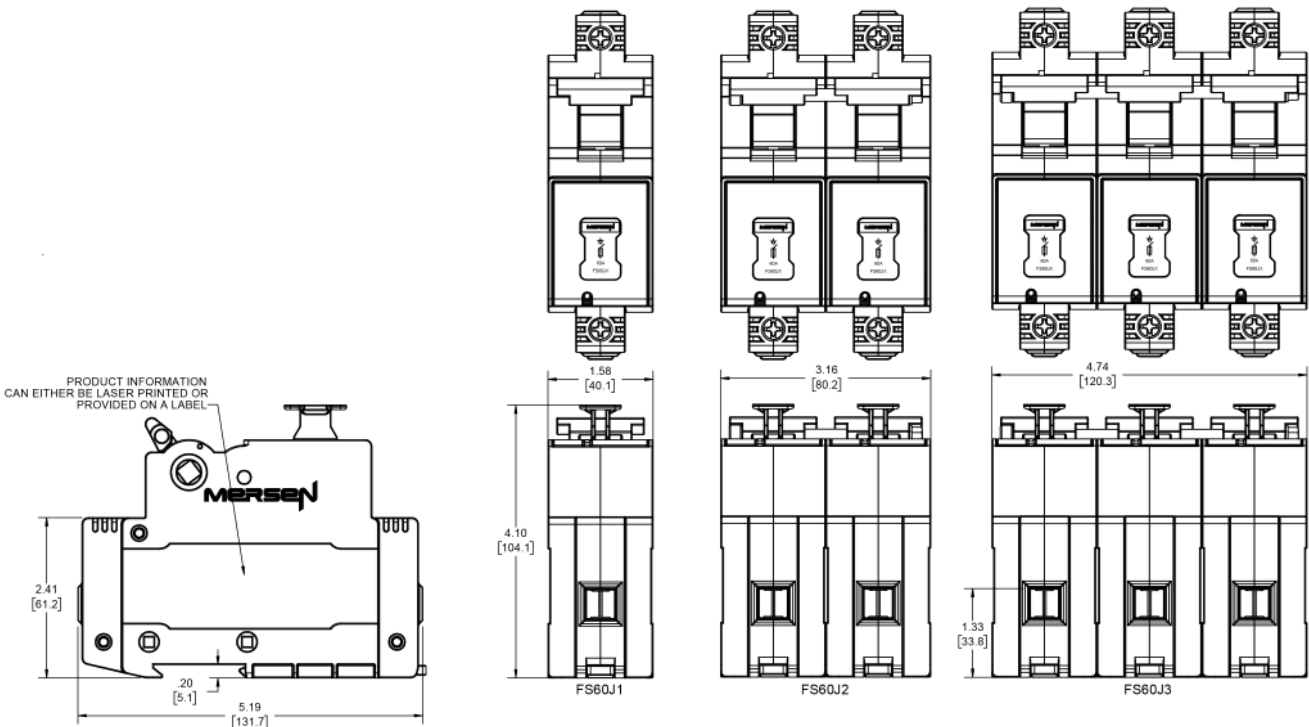

© 2024 Mersen. All rights reserved. Mersen reserves the right to change, update, or correct, without notice, any information contained in this datasheet.